

430-450 S. Curtis Road
Milwaukee, WI

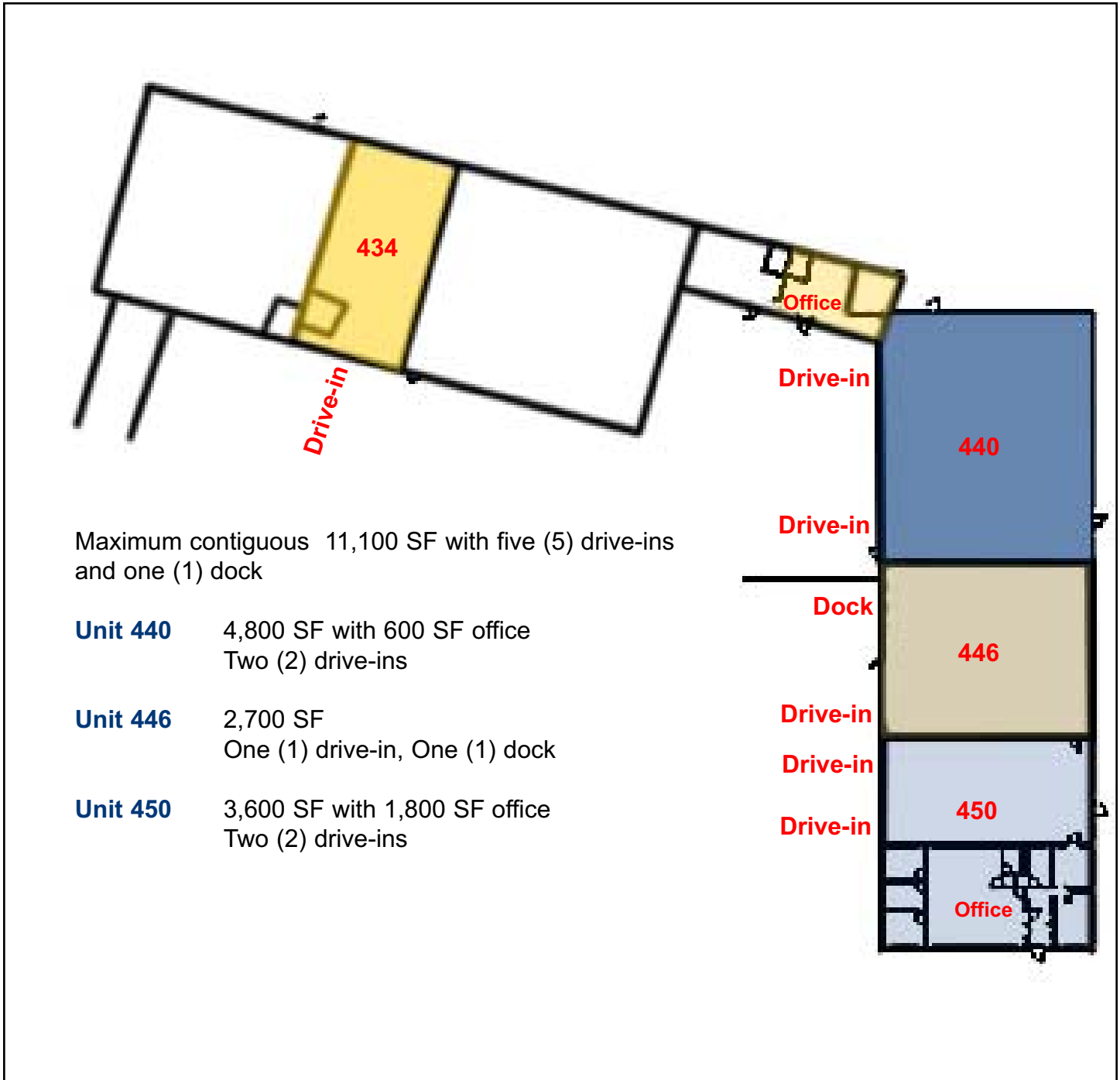

GRUBB & ELLIS[®]
Apex Commercial

LOCAL PRESENCE GLOBAL REACH

Information shown herein was furnished by sources deemed reliable and is believed to be accurate, however, no warranty or representation is made as to the accuracy thereof and is subject to correction. Prices subject to change without notice.

430-450 S. Curtis Road Milwaukee, WI



- Unit 450 1,800 SF Office
1,800 SF with Two (2) Drive-in and Sewer
- Unit 446 2,700 SF with One (1) Dock, One (1) Drive-in

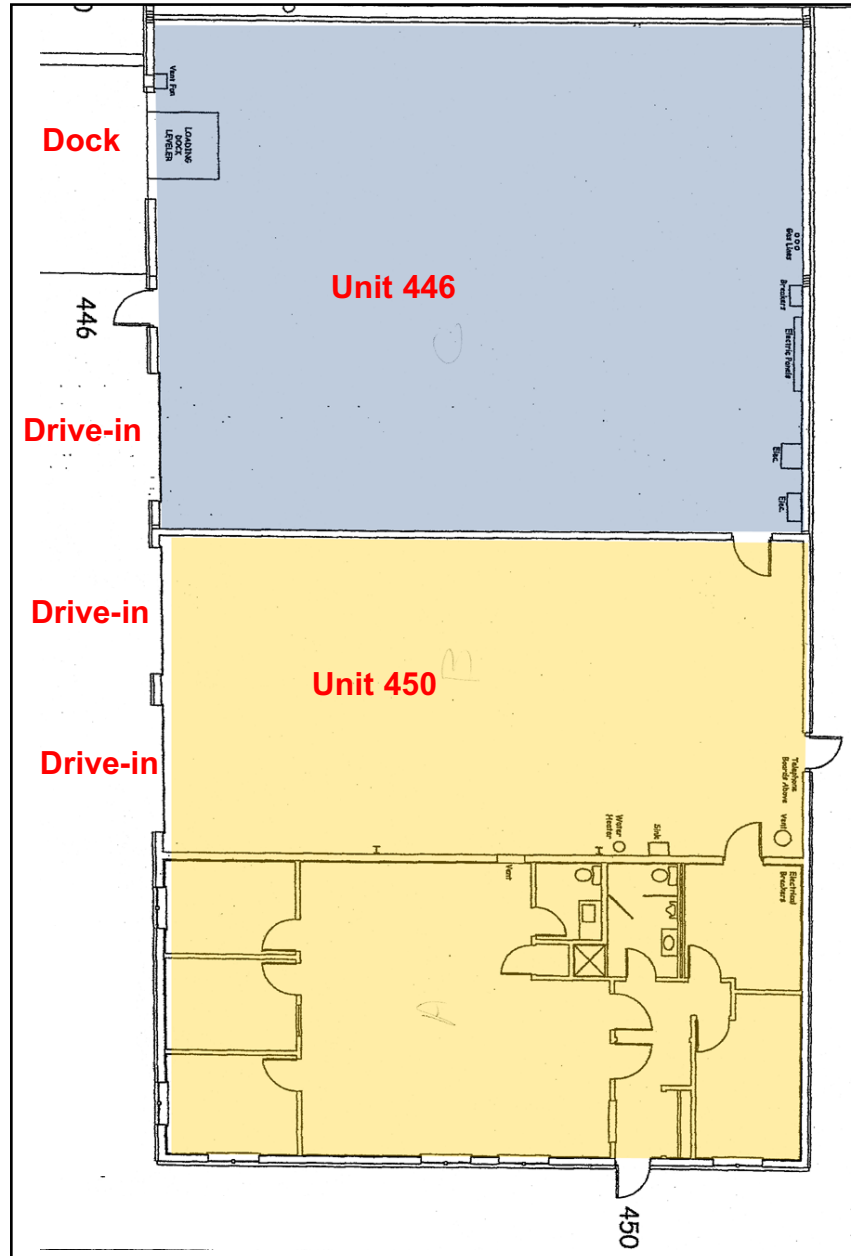

GRUBB & ELLIS
Apex Commercial

LOCAL PRESENCE GLOBAL REACH

Information shown herein was furnished by sources deemed reliable and is believed to be accurate, however, no warranty or representation is made as to the accuracy thereof and is subject to correction. Prices subject to change without notice.